

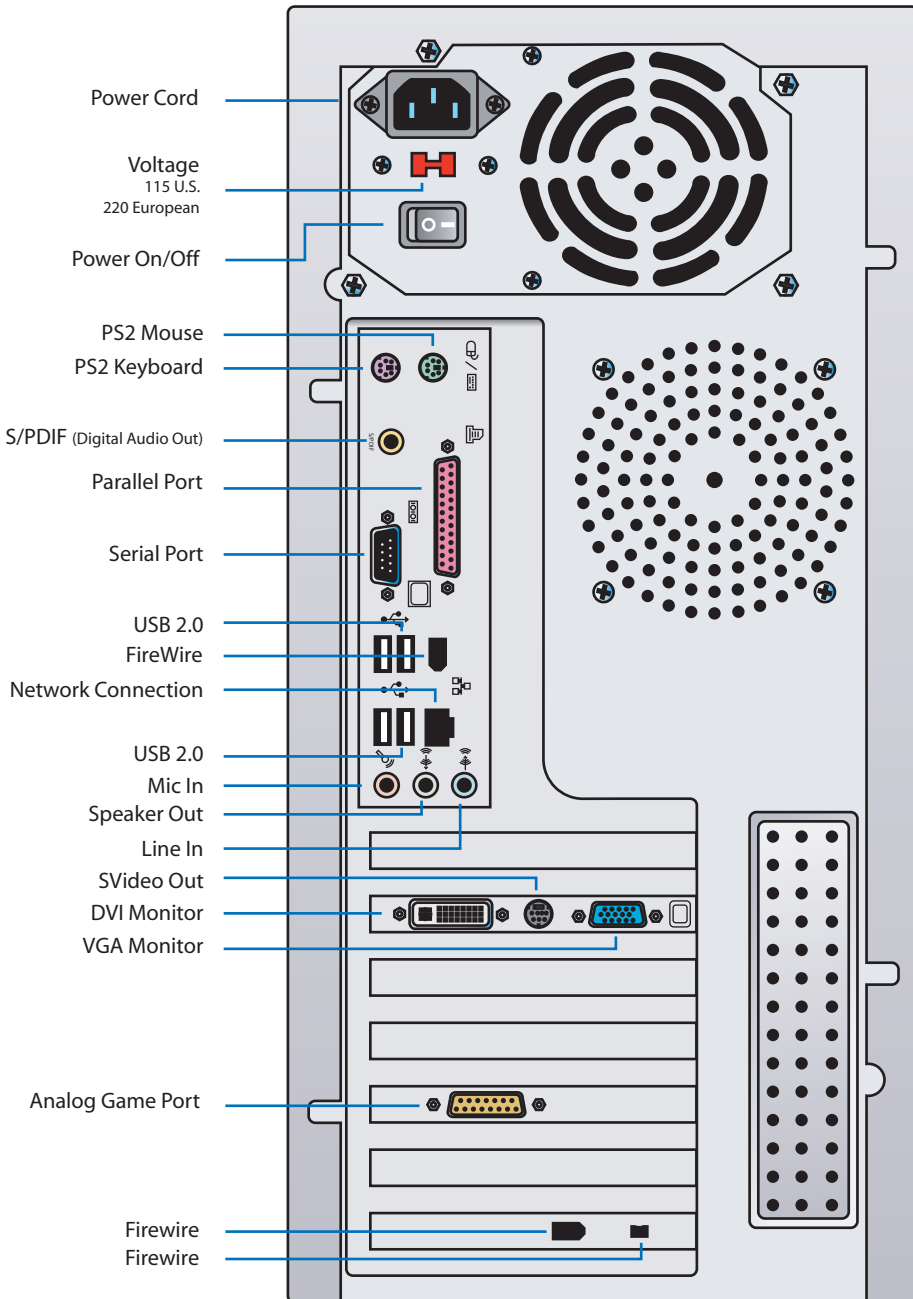

Back

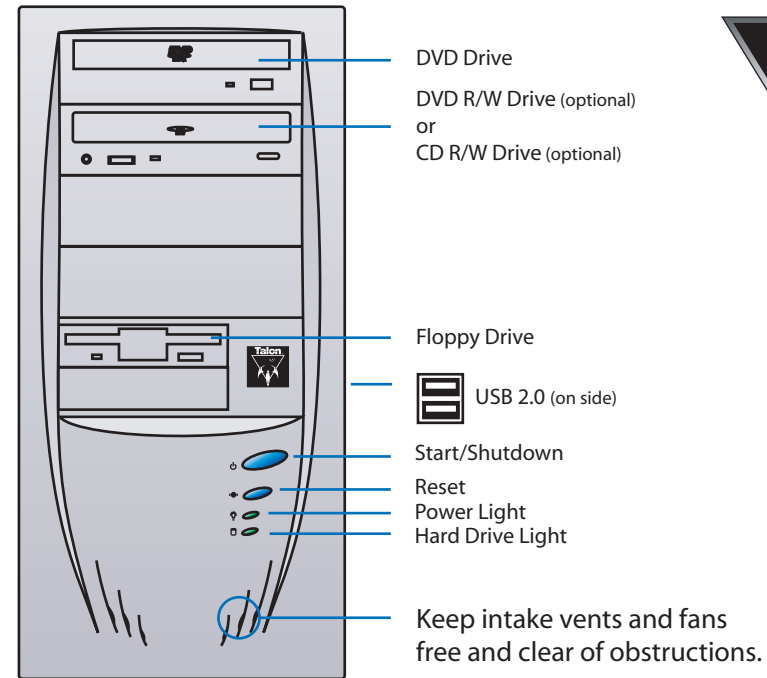

Front



Optional Hardware

Audigy Sound Card

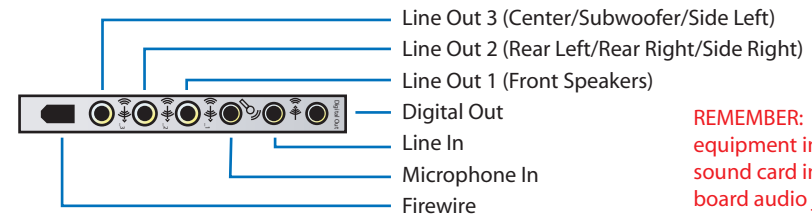

REMEMBER: Plug your audio equipment into the Audigy sound card instead of the on-board audio jacks.

Internal Modem

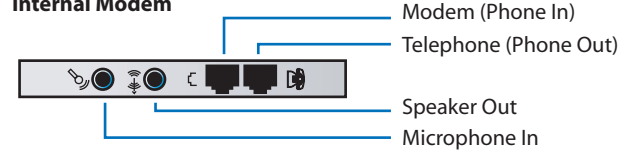

Depending on the Talon model number and the optional hardware you ordered, these cards may be on the back of your computer in the expansion slots.

For Falcon Northwest technical support please call (888) 800-7440. Or E-mail us at support@falcon-nw.com.